

INSTALLATION INSTRUCTIONS
Linear Lighting _ 299 Lighting

OKA
SURFACE

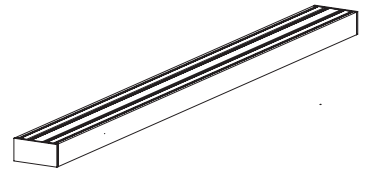

OKA SURFACE

INSTALLATION INSTRUCTIONS

Linear_299Lighting

Inside the box

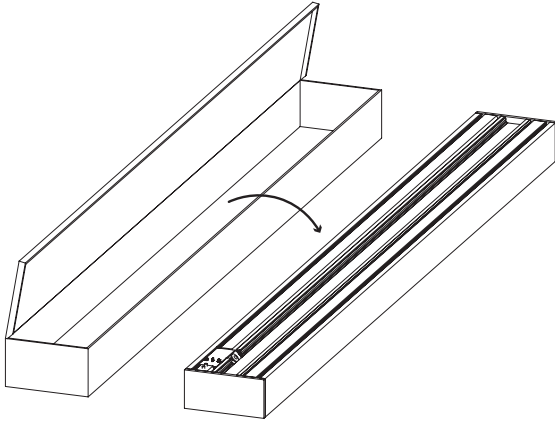

Electrical Connection

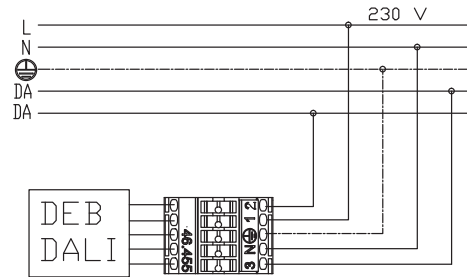
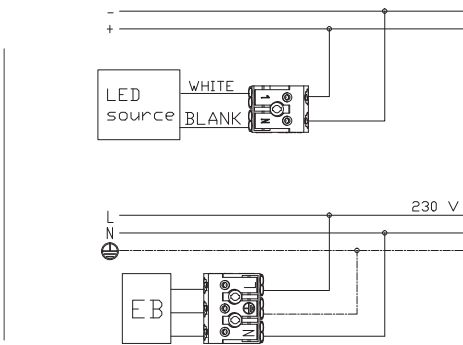

Safety Message

- a) Only competent persons are allowed to perform mounting and maintenance.
- b) Before installation make sure that there is no voltage in the network.
- c) Use only original parts for repairs or maintenance.
- d) Use only fixtures with proper IP protection in wet rooms.
- e) Before servicing, it is obligatory to disconnect the fixture from the network voltage.
- f) Manufacturer does not guarantee for damage caused by incorrect installation and/or use.
- g) Any operation performed on the fixture that is not in accordance with instructions will void manufacturer's warranty.



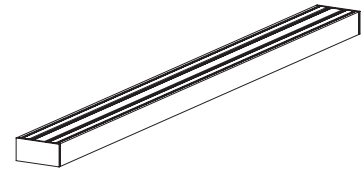

OKA SURFACE

INSTALLATION INSTRUCTIONS

Linear_299Lighting

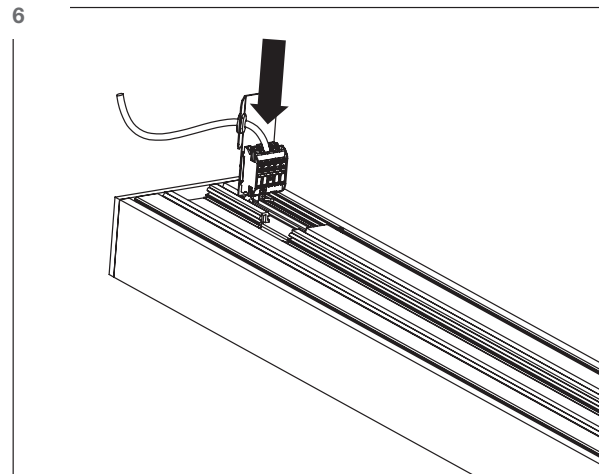
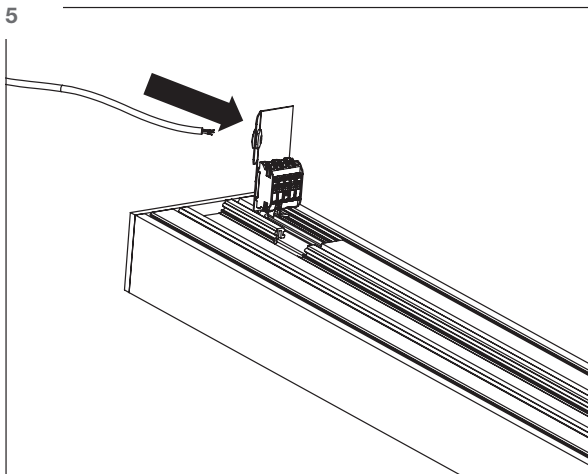
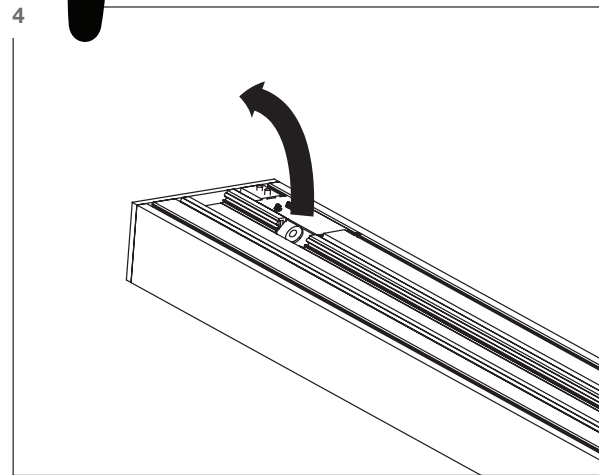
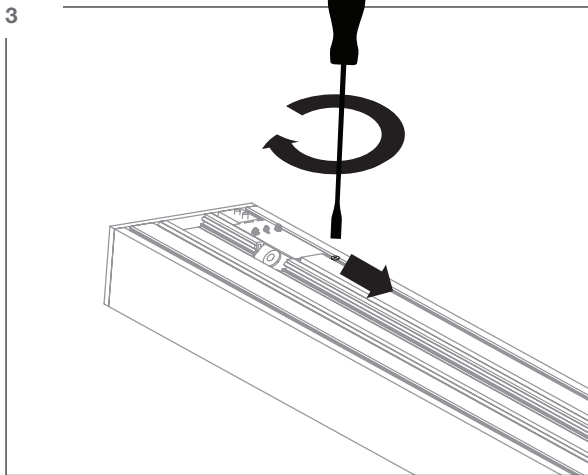
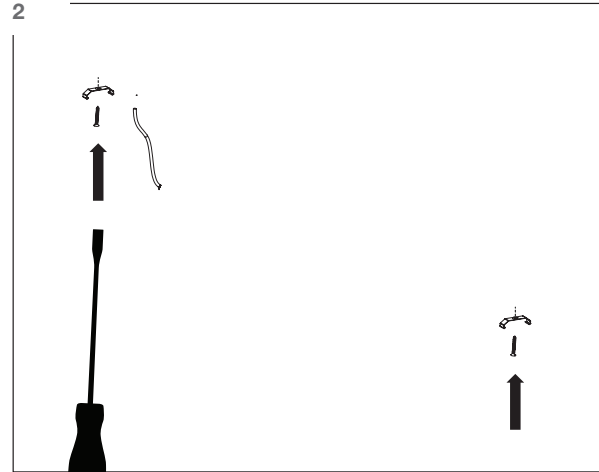
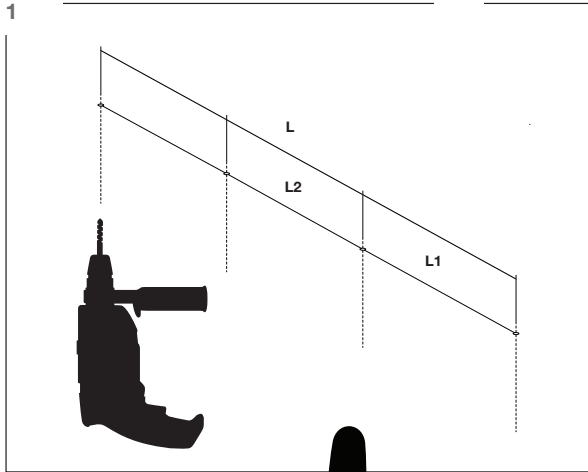

OKA SURFACE

INSTALLATION INSTRUCTIONS

Linear_299Lighting

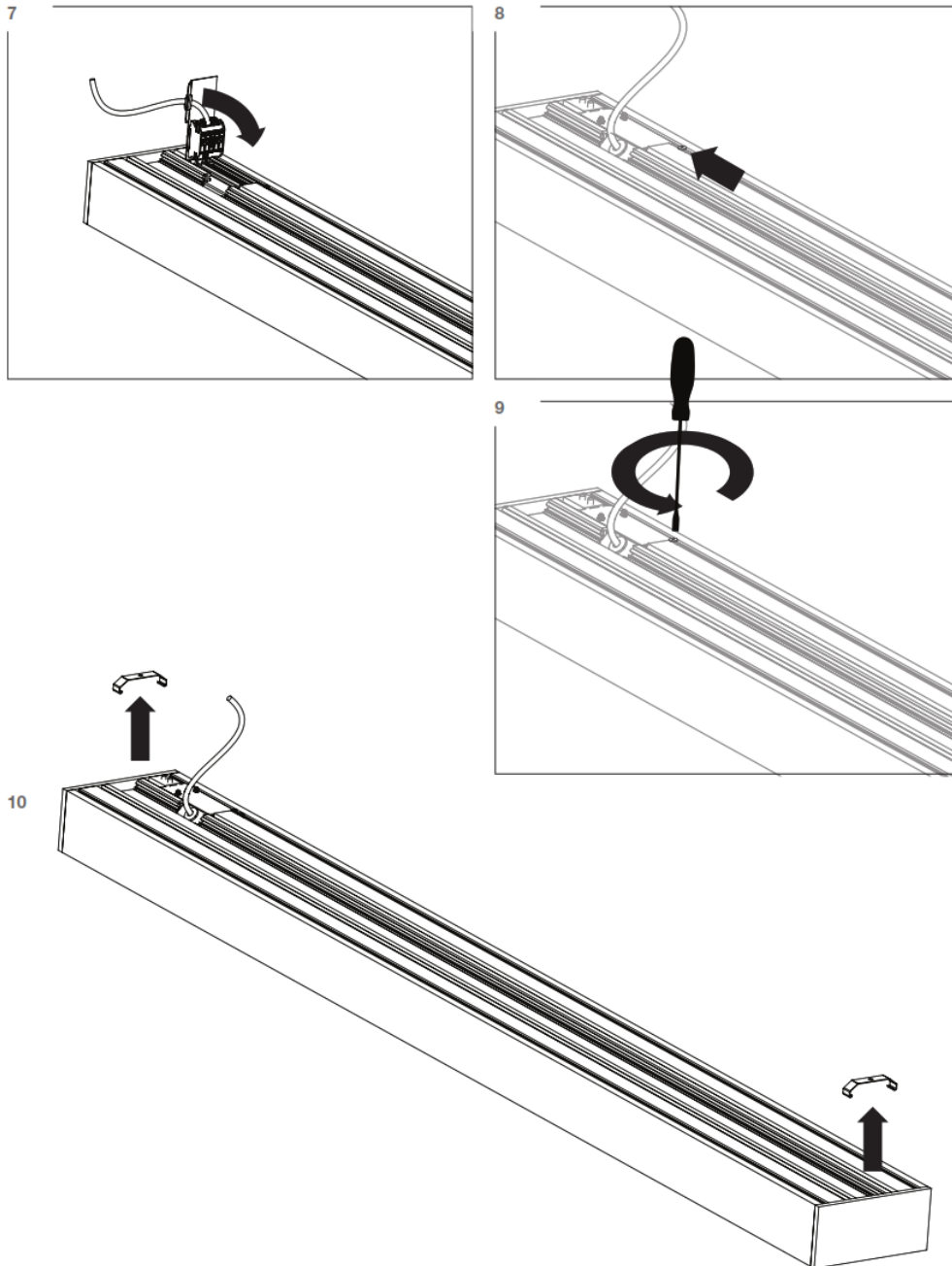

OKA SURFACE

INSTALLATION INSTRUCTIONS

Linear_299Lighting

11

