

11-A*1-F53/15/24-8**-*0-*	L = 561mm
11-A*1-F79/22/37-8**-*0-*	L = 842mm
11-A*1-F10/30/49-8**-*0-*	L = 1122mm
11-A*1-F13/38/62-8**-*0-*	L = 1403mm
11-A*1-F16/45/74-8**-*0-*	L = 1683mm
11-A*1-F**/*/*-8**-*0-*	L = 1964mm
11-A*1-F21/60/99-8**-*0-*	L = 2244mm
11-A*1-F**/*/*-8**-*0-*	L = 3366mm
11-A*1-F**/*/*-8**-*0-*	L = 4488mm

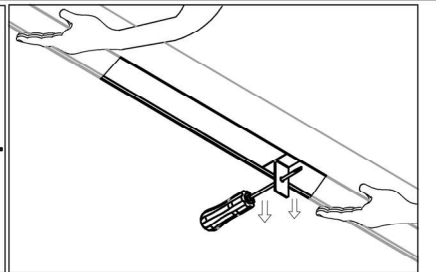
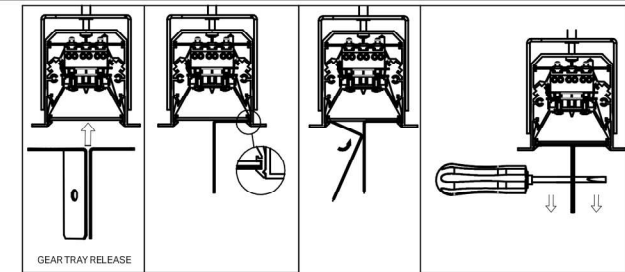
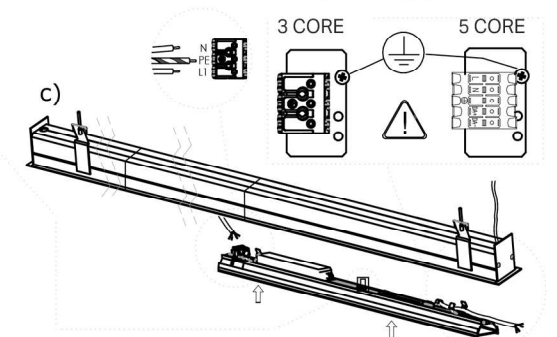
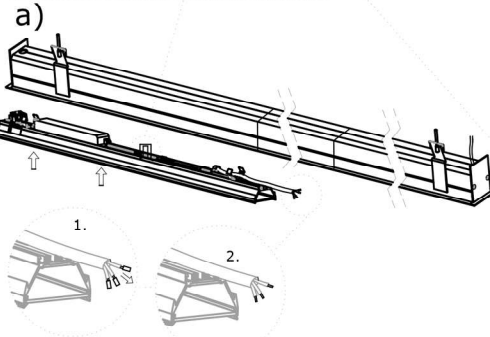
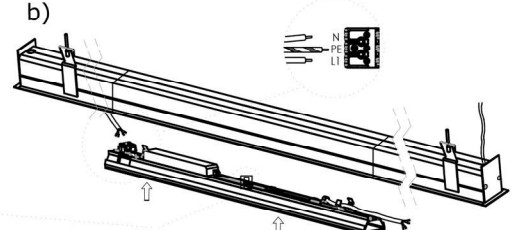
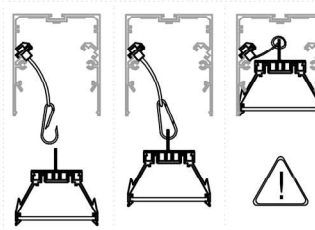
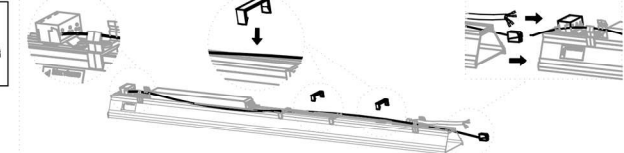
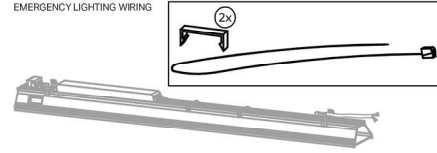
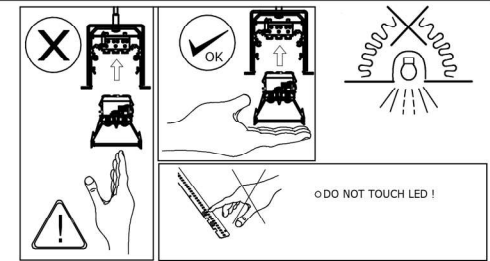
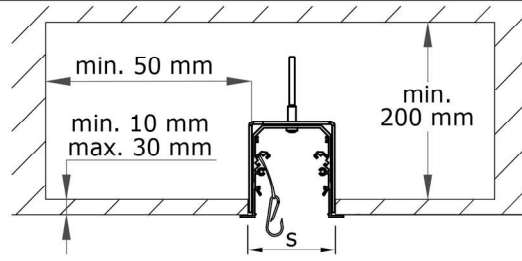
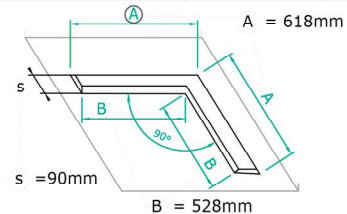
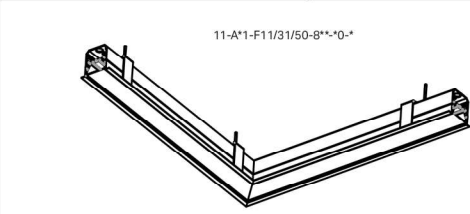
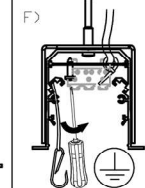
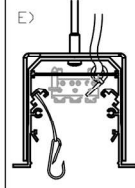
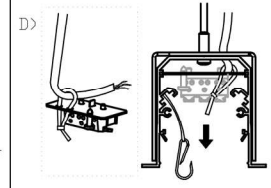
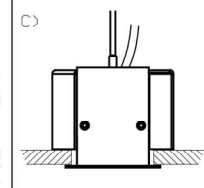
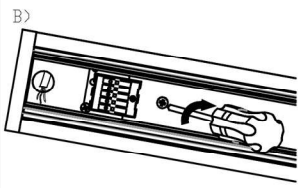
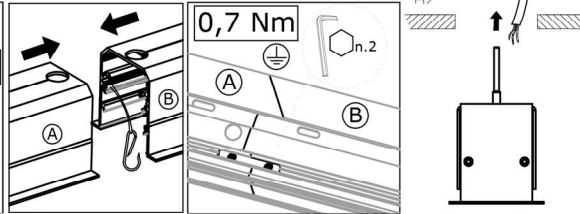
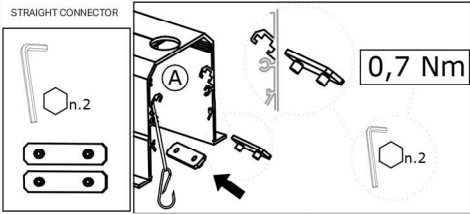
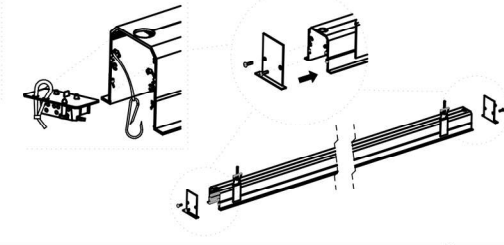
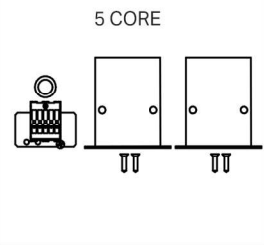
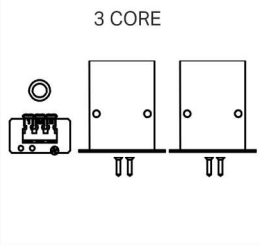
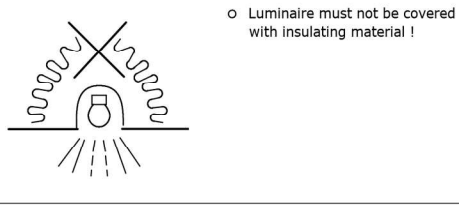
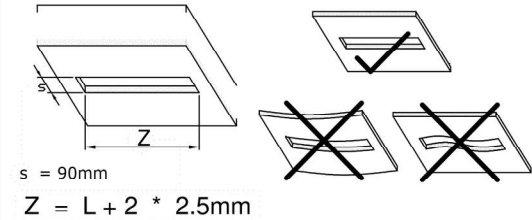

- o The installation may only be carried by authorised specialist. Always switch-off the power supply before carrying out any maintenance.
- o The manufacturer is not responsible for the incorrect use and assembly of its products.